

**MATERIAL CHARACTERISTICS**

<b>FIBERGLASS COMPOSITE</b>	glass-fibre-reinforced polyester, mineral fillers, additives
<b>TENSILE STRENGTH</b>	65 N/mm <sup>2</sup> (ISO 527)
<b>BENDING STRENGTH</b>	120 N/mm <sup>2</sup> (ISO 14125)
<b>ELASTICITY MODULE</b>	10.000 N/mm <sup>2</sup> (ISO 14125)
<b>DENSITY</b>	2,0 g/cm <sup>3</sup> (ISO 1172)
<b>COEFFICIENT OF LINEAR EXPANSION</b>	1,5 - 2,0 x 10 <sup>-5</sup> 1/K
<b>HEAT RESISTANCE</b>	100°C continuous load, up to 240°C with a load duration up to 110 min.
<b>FROST RESISTANCE</b>	-35°C
<b>WATER PENETRATION LEVEL</b>	0 mm
<b>WATER ABSORPTION</b>	0,078 % (EN ISO 62:2008-05 Procedure 1)
<b>MATERIAL STRUCTURE</b>	Capillary free

**PURPOSE OF USE**

Component for the line drainage of surfaces in order to collect, transport and discharge rainwater from adjacent fixed surfaces.

\*\* ) Not suitable for the diagonal or transverse travel of motorways and highways.

# MEARIN EXPERT V 2000

A 15, B 125, C 250, D 400\*\*, E 600\*\*

nominal width 200

## MEARIN EXPERT 2000 DRAINAGE CHANNEL WITHOUT FALL WITH INTEGRATED EDGE MADE OF GALVANISED STEEL (V) OR STAINLESS STEEL (E) AND SEALING JOINT ACCORDING TO EN 1433

Channel made of glass-fibre-reinforced composite material. Clear width 200 mm, total width 232 mm. Suitable for all channel covers **MEA 200 CLIPFIX** and **MEA TSH 200 TOPSLOT**. For the realisation of water level slopes. Loading classes A 15 to E 600\*\* according to EN 1433. Load capacity according to specification when installed according to the MEA installation instructions.

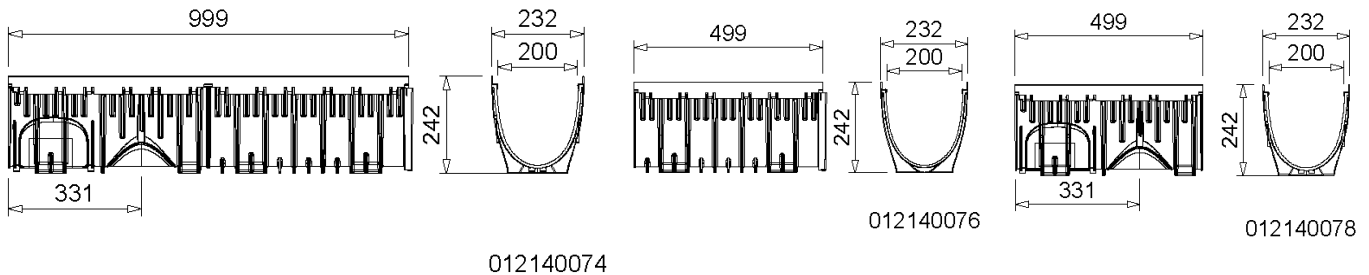

### MEARIN EXPERT V 2000 DRAINAGE CHANNEL BODY WITHOUT FALL, LOADING CLASSES UP TO E 600\*\*)

Designation	Ord. No.	Length [mm]	Height [mm]	kg/unit
MEARIN EXPERT V 2000.0 Drainage channel body 5) 14) **)	012140074	1000	242	7,80
MEARIN EXPERT V 2000.1 Drainage channel body 3) **)	012140076	500	242	4,30
MEARIN EXPERT V 2000.1 RW Drainage channel body for change of drain direction 5) 14) 15) **)	012140078	500	242	4,30
MEARIN EXPERT V 2010.0 Drainage channel body 5) **)	012140300	1000	292	9,31
MEARIN EXPERT V 2010.1 Drainage channel body 3) **)	012140302	500	292	4,66
MEARIN EXPERT V 2010.1 RW Drainage channel body for change of drain direction 5) 15) **)	012140304	500	292	4,66
MEARIN EXPERT V 2020.0 Drainage channel body 5) **)	012140326	1000	342	10,14
MEARIN EXPERT V 2020.1 Drainage channel body 3) **)	012140328	500	342	5,07
MEARIN EXPERT V 2020.1 RW Drainage channel body for change of drain direction 5) 15) **)	012140330	500	342	5,07

### MEARIN EXPERT E 2000 DRAINAGE CHANNEL BODY WITHOUT FALL, LOADING CLASSES UP TO E 600\*\*)

Designation	Ord. No.	Length [mm]	Height [mm]	kg/unit
MEARIN EXPERT E 2000.0 Drainage channel body 5) 14) **)	012140920	1000	242	7,80
MEARIN EXPERT E 2000.1 Drainage channel body 3) **)	012140922	500	242	4,30
MEARIN EXPERT E 2000.1 RW Drainage channel body for change of drain direction 5) 14) 15) **)	012140924	500	242	4,30
MEARIN EXPERT E 2010.0 Drainage channel body 5) **)	012140926	1000	292	9,31
MEARIN EXPERT E 2010.1 Drainage channel body 3) **)	012140928	500	292	4,66
MEARIN EXPERT E 2010.1 RW Drainage channel body for change of drain direction 5) 15) **)	012140930	500	292	4,66
MEARIN EXPERT E 2020.0 Drainage channel body 5) **)	012140932	1000	342	10,14
MEARIN EXPERT E 2020.1 Drainage channel body 3) **)	012140934	500	342	5,07
MEARIN EXPERT E 2020.1 RW Drainage channel body for change of drain direction 5) 15) **)	012140936	500	342	5,07

\*\*) Not suitable for the diagonal or transverse travel of motorways and highways.

3) Connection option for end caps with connector or for gullies / silt boxes.

5) Connection option for vertical drain Ø 160 mm (drainage preformation), end caps with connector or to gullies / silt boxes.

14) Connection option for corner-, T- and cross- connections.

15) Utilization option as a flow direction change.

# MEARIN EXPERT V 2000

A 15, B 125, C 250, D 400\*\*, E 600\*\*

nominal width 200

## MEARIN EXPERT 2000 DRAINAGE CHANNEL WITH FALL (0.5%) WITH INTEGRATED EDGE MADE OF GALVANISED STEEL (V) OR STAINLESS STEEL (E) AND SEALING JOINT ACCORDING TO EN 1433

Channel body made of glass fiber reinforced composite. Clear width 200 mm, total width 232 mm. Suitable for all channel covers **MEA 200 CLIPFIX** and **TOPSLOTS MEA TSH 200**. For the realisation of linear fall (with fall 0.5%). Loading classes A 15 to E 600\*\* according to EN 1433. Load capacity according to specification when installed according to the MEA installation instructions.

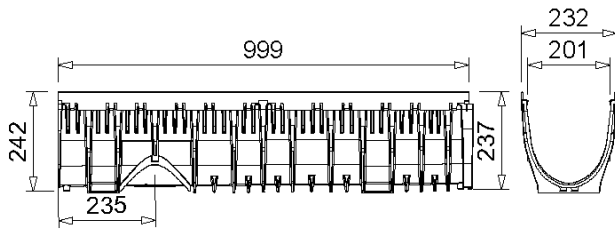

012140280

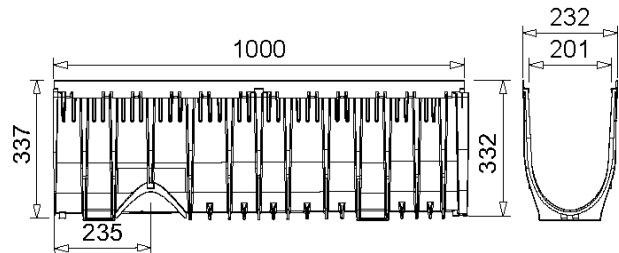

012140324

## MEARIN EXPERT V 2000 DRAINAGE CHANNEL BODY WITH 0.5% FALL, LOADING CLASSES UP TO E 600 \*\*)

Designation	Ord. No.	Length [mm]	Height [mm]	Height 2 [mm]	kg/unit
MEARIN EXPERT V 2001 Drainage channel body 2) 5) **)	012140280	1000	242	247	8,17
MEARIN EXPERT V 2002 Drainage channel body 2) 5) **)	012140282	1000	247	252	8,25
MEARIN EXPERT V 2003 Drainage channel body 2) 5) **)	012140284	1000	252	257	8,32
MEARIN EXPERT V 2004 Drainage channel body 2) 5) **)	012140286	1000	257	262	8,40
MEARIN EXPERT V 2005 Drainage channel body 2) 5) **)	012140288	1000	262	267	8,47
MEARIN EXPERT V 2006 Drainage channel body 2) 5) **)	012140290	1000	267	272	8,55
MEARIN EXPERT V 2007 Drainage channel body 2) 5) **)	012140292	1000	272	277	8,63
MEARIN EXPERT V 2008 Drainage channel body 2) 5) **)	012140294	1000	277	282	8,70
MEARIN EXPERT V 2009 Drainage channel body 2) 5) **)	012140296	1000	282	287	8,78
MEARIN EXPERT V 2010 Drainage channel body 2) 5) **)	012140298	1000	287	292	8,85
MEARIN EXPERT V 2011 Drainage channel body 2) 5) **)	012140306	1000	292	297	8,93
MEARIN EXPERT V 2012 Drainage channel body 2) 5) **)	012140308	1000	297	302	9,01
MEARIN EXPERT V 2013 Drainage channel body 2) 5) **)	012140310	1000	302	307	9,08
MEARIN EXPERT V 2014 Drainage channel body 2) 5) **)	012140312	1000	307	312	9,16
MEARIN EXPERT V 2015 Drainage channel body 2) 5) **)	012140314	1000	312	317	9,23
MEARIN EXPERT V 2016 Drainage channel body 2) 5) **)	012140316	1000	317	322	9,31
MEARIN EXPERT V 2017 Drainage channel body 2) 5) **)	012140318	1000	322	327	9,39
MEARIN EXPERT V 2018 Drainage channel body 2) 5) **)	012140320	1000	327	332	9,46
MEARIN EXPERT V 2019 Drainage channel body 2) 5) **)	012140322	1000	332	337	9,54
MEARIN EXPERT V 2020 Drainage channel body 2) 5) **)	012140324	1000	337	342	9,61

\*\*) Not suitable for the diagonal or transverse travel of motorways and highways.

2) Connection option for vertical drain Ø 160 mm.

5) Connection option for vertical drain Ø 160 mm (drainage preformation), end caps with connector or to gullies / silt boxes.

# MEARIN EXPERT V 2000

A 15, B 125, C 250, D 400\*\*, E 600\*\*

nominal width 200



BUILDING SUCCESS

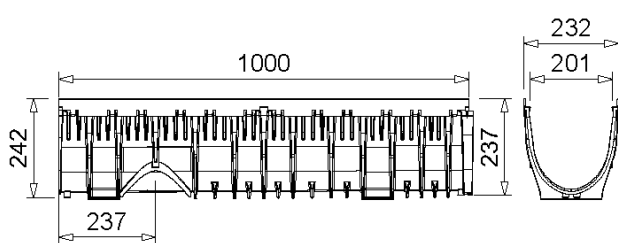

012140938

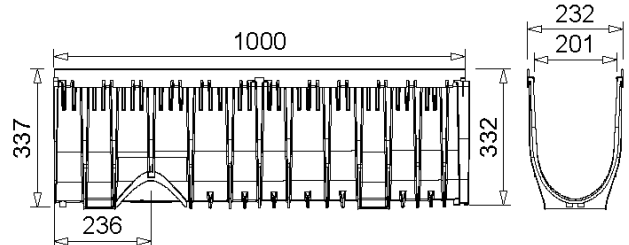

012140976

## MEARIN EXPERT E 2000 DRAINAGE CHANNEL BODY WITH 0.5% FALL, LOADING CLASSES UP TO E 600 \*\*)

Designation	Ord. No.	Length [mm]	Height [mm]	Height 2 [mm]	kg/unit
MEARIN EXPERT E 2001 Drainage channel body 2) 5) **)	012140938	1000	242	247	8,17
MEARIN EXPERT E 2002 Drainage channel body 2) 5) **)	012140940	1000	247	252	8,25
MEARIN EXPERT E 2003 Drainage channel body 2) 5) **)	012140942	1000	252	257	8,32
MEARIN EXPERT E 2004 Drainage channel body 2) 5) **)	012140944	1000	257	262	8,40
MEARIN EXPERT E 2005 Drainage channel body 2) 5) **)	012140946	1000	262	267	8,47
MEARIN EXPERT E 2006 Drainage channel body 2) 5) **)	012140948	1000	267	272	8,55
MEARIN EXPERT E 2007 Drainage channel body 2) 5) **)	012140950	1000	272	277	8,63
MEARIN EXPERT E 2008 Drainage channel body 2) 5) **)	012140952	1000	277	282	8,70
MEARIN EXPERT E 2009 Drainage channel body 2) 5) **)	012140954	1000	282	287	8,78
MEARIN EXPERT E 2010 Drainage channel body 2) 5) **)	012140956	1000	287	292	8,85
MEARIN EXPERT E 2011 Drainage channel body 2) 5) **)	012140958	1000	292	297	8,93
MEARIN EXPERT E 2012 Drainage channel body 2) 5) **)	012140960	1000	297	302	9,01
MEARIN EXPERT E 2013 Drainage channel body 2) 5) **)	012140962	1000	302	307	9,08
MEARIN EXPERT E 2014 Drainage channel body 2) 5) **)	012140964	1000	307	312	9,16
MEARIN EXPERT E 2015 Drainage channel body 2) 5) **)	012140966	1000	312	317	9,23
MEARIN EXPERT E 2016 Drainage channel body 2) 5) **)	012140968	1000	317	322	9,31
MEARIN EXPERT E 2017 Drainage channel body 2) 5) **)	012140970	1000	322	327	9,39
MEARIN EXPERT E 2018 Drainage channel body 2) 5) **)	012140972	1000	327	332	9,46
MEARIN EXPERT E 2019 Drainage channel body 2) 5) **)	012140974	1000	332	337	9,54
MEARIN EXPERT E 2020 Drainage channel body 2) 5) **)	012140976	1000	337	342	9,61

\*\*) Not suitable for the diagonal or transverse travel of motorways and highways.

2) Connection option for vertical drain Ø 160 mm.

5) Connection option for vertical drain Ø 160 mm (drainage preformation), end caps with connector or to gullies / silt boxes.

**MEARIN EXPERT 2000 ACCESSORIES**

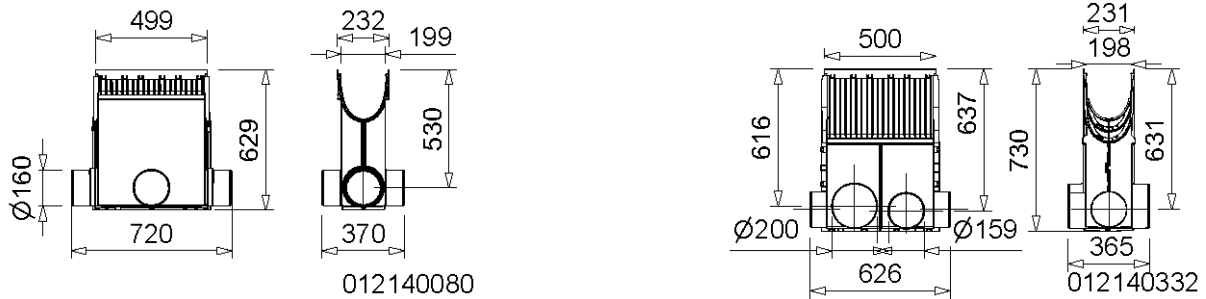

**MEARIN EXPERT V 2000 SILT BOX WITHOUT COVER, WITH SEDIMENT BUCKET \*\*)**

Designation	Ord. No.	Length [mm]	Height [mm]	kg/unit
MEARIN EXPERT V 2000.EK silt box with pipe connector Ø 160 mm, incl. sediment bucket **)	012140080	500	630	8,80
MEARIN EXPERT V 2000-2020.EK silt box with pipe connector Ø 160 mm/ Ø 200 mm, incl. sediment bucket **)	012140332	500	730	12,80
MEARIN PLUS / EXPERT 2000 sediment bucket	010710067	-	-	0,70

**MEARIN EXPERT E 2000 SILT BOX WITHOUT COVER, WITH SEDIMENT BUCKET \*\*)**

Designation	Ord. No.	Length [mm]	Height [mm]	kg/unit
MEARIN EXPERT E 2000.EK silt box with pipe connector Ø 160 mm, incl. sediment bucket **)	012140978	500	630	8,80
MEARIN EXPERT E 2000-2020.EK silt box with pipe connector Ø 160 mm/ Ø 200 mm, incl. sediment bucket **)	012140980	500	730	12,80
MEARIN PLUS / EXPERT 2000 sediment bucket	010710067	-	-	0,70

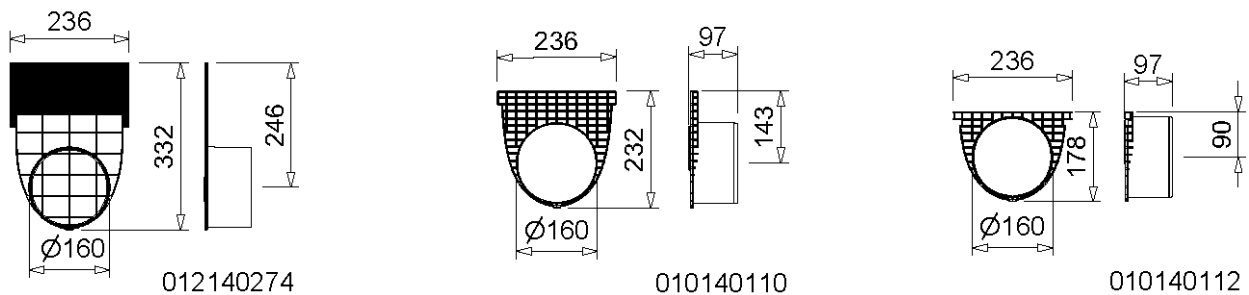

**MEARIN PLUS/EXPERT 2000 END CAPS**

Designation	Ord. No.	Height [mm]	Material	kg/unit
MEARIN PLUS/EXPERT 2000-2020.SE/Ø160 End cap closed, for channel start/end with preforming for Ø 160 mm pipe connection	012140274	332	PC	0,30
MEARIN PLUS/EXPERT 2000.SE End cap closed for channel start/end	010140108	323	PC	0,18
MEARIN PLUS/EXPERT 2000.E End cap with outlet Ø 160 mm for channel end	010140110	232	PP	0,19
MEARIN PLUS/EXPERT 2000.ES End cap with outlet Ø 160 mm for lateral channel connector *)	010140112	178	PP	0,24

\*) Delivery time upon request.

\*\*) Not suitable for the diagonal or transverse travel of motorways and highways.

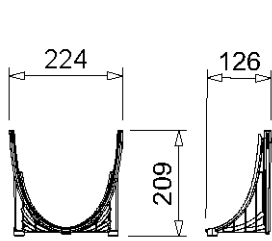

010140114

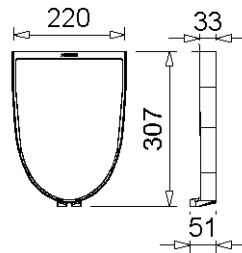

010140894

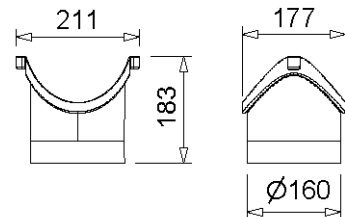

010140117

**MEARIN PLUS/EXPERT 2000 CONNECTION ACCESSORIES**

Designation	Ord. No.	Height [mm]	Material	kg/unit
MEARIN PLUS/EXPERT 2000.0 adapter for lateral channel connection, to corner, T and cross connections	010140114	209	PP	0,09
MEARIN PLUS/EXPERT 2010.0 adapter for lateral channel connection, for corner, T and cross connections	010140628	261	PC	0,15
MEARIN PLUS/EXPERT 2020.0 adapter for lateral channel connection, for corner, T and cross connections	010140890	311	PC	0,16
MEARIN PLUS/EXPERT 2010.T channel connector for low point channels no. 10	010140892	257	PC	0,09
MEARIN PLUS/EXPERT 2020.T channel connector for low point channels no. 20	010140894	307	PC	0,10
MEARIN PLUS/EXPERT 1500 - 2000 Vertical outlet connection Ø 160 mm	010140117	182	PP	0,14
MEARIN PLUS/EXPERT 2000 Odour trap with dirt filter and dirt trap	010140546	-	PP, Galv. steel	2,00

**JOINTING COMPOUNDS FOR STANDARD APPLICATIONS \*\*\*)**

Designation	Ord. No.	Material	kg/unit
SABA MS Floor GREY sealant 600 ml in a bag, stable ***)	010152708	MS-Polymer-Basis	0,88
SABA MS Floor BLACK sealant 600 ml in a bag, stable ***)	010152700	MS-Polymer-Basis	0,84
SABA Primer 9102 for undercoat, 1 liter	010155803	Silan-Basis	0,92
Joint Cleaner solvent 48, 1 liter, Cleaner for adhesive flanks	010155807	-	0,84
Dispensing gun for 600 ml bags	010152707	-	0,63

\*\*\*) For watertight mounting of drainage channels (only for channels transporting rainwater). Not suitable for installation in LAU facilities, gaz stations or similar constructions.

This edition of the technical data sheet shall be valid from February 2024 until a revised version is published and replaces any previous publications. The respectively current version is available for download at [www.mea-group.com](http://www.mea-group.com).

MEA Bautechnik GmbH  
 Business unit MEA Water Management  
 Sudetenstraße 1  
 86551 Aichach  
 Tel.: +49 (0) 82 51. 91 0  
 Fax: +49 (0) 82 51. 91 13 06  
 E-Mail: [info@mea-group.com](mailto:info@mea-group.com)  
[www.mea-group.com](http://www.mea-group.com)