

MEARIN PLUS / F / BLACK 2000

A 15, B 125, C 250, D 400** Nominal width 200

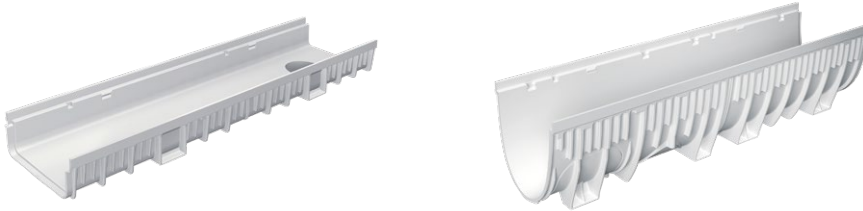

BUILDING SUCCESS



MEARIN PLUS F 2000.0 A/100

MEARIN PLUS 2000.0

Material properties

FIBERGLASS COMPOSITE	glass-fibre-reinforced polyester, mineral fillers, additives
TENSILE STRENGTH	65 N/mm ² (ISO 527)
BENDING STRENGTH	120 N/mm ² (ISO 14125)
ELASTICITY MODULE	10.000 N/mm ² (ISO 14125)
DENSITY	2,0 g/cm ³ (ISO 1172)
COEFFICIENT OF LINEAR EXPANSION	1,5 – 2,0 x 10 ⁻⁵ 1/K
HEAT RESISTANCE	100°C continuous load, up to 240°C with a load duration up to 110 min
FROST RESISTANCE	-35°C
WATER PENETRATION LEVEL	0 mm
WATER ABSORPTION	< 0,078 % (EN ISO 62:2008-05 Procedure 1)
MATERIAL STRUCTURE	Capillary free

Purpose of use

- > Component for the line drainage of surfaces in order to collect, transport and discharge rain water from adjacent fixed surfaces.

MEARIN PLUS / F / BLACK 2000

A 15, B 125, C 250, D 400** Nominal width 200



BUILDING SUCCESS

MEARIN PLUS F 2000 SHALLOW DRAINAGE CHANNEL WITH GRP EDGE AND SEALING JOINT ACCORDING TO EN 1433

Shallow channel made of glass-fibre-reinforced composite material. Clear width 200 mm, total width 237 mm. Suitable for all channel covers **MEA 200 CLIPFIX** and **MEA TS-P 200 TOPSLOT**. For the realisation of water level slopes. Loading classes A 15 to D 400** according to EN 1433. Load capacity according to specification when installed according to the MEA installation instructions.

MEARIN PLUS F 2000 shallow complete drainage channel incl. cover without fall. Loading classes up to D 400 **)

Description	Length (mm)	Height (mm)	EAN-Code	kg/unit
MEARIN PLUS F 2000.0/100 shallow drainage channel incl. ductile iron grating-C 250-1 m CXL ^{5) 14) *) **)}	1000	100	012140362	18,90

*) Delivery time upon request

**) Not suitable for the diagonal or transverse travel of motorways and highways.

5) Connection option for vertical drain Ø 160 mm (drainage preformation), end caps with connector or to gullies / silt boxes.

14) Connection option for corner-, T- and cross- connections.

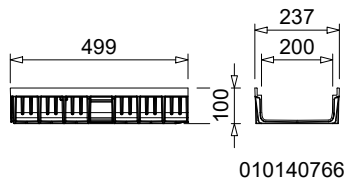
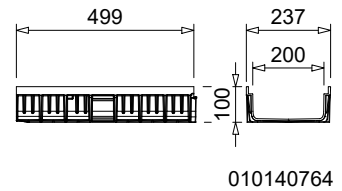
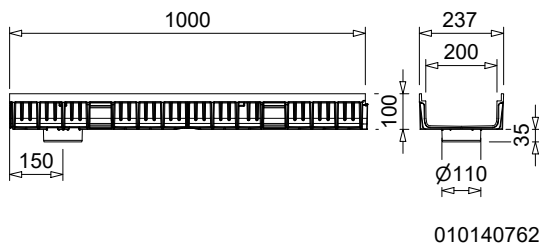

MEARIN PLUS F (BLACK) 2000 Shallow drainage channel body without fall, loading classes up to D 400 **)

Description	Length (mm)	Height (mm)	EAN-Code	kg/unit
MEARIN PLUS F 2000.0/100 shallow drainage channel body **)	1000	100	010140760	3,38
MEARIN PLUS F 2000.0 A/100 shallow drainage channel body with Ø 110 mm outlet ^{8) **)}	1000	100	010140762	3,38
MEARIN PLUS F 2000.1/100 shallow drainage channel body **)	500	100	010140764	1,69

**) Not suitable for the diagonal or transverse travel of motorways and highways.

8) With tight formed-in drain outlet Ø 110 mm

15) Utilization option as a flow direction change

MEARIN PLUS / F / BLACK 2000

A 15, B 125, C 250, D 400** Nominal width 200

**BUILDING SUCCESS****MEARIN PLUS F (BLACK) 2000 Shallow drainage channel body without fall, loading classes up to D 400 **)**

Description	Length (mm)	Height (mm)	EAN-Code	kg/unit
MEARIN PLUS F 2000.1 RW/100 shallow drainage channel body for change of drain direction ¹⁵⁾ **)	500	100	010140766	1,69
MEARIN PLUS F BLACK 2000.0/100 shallow drainage channel body ^{**)}	1000	100	010140763	3,38
MEARIN PLUS F BLACK 2000.0 A/100 shallow drainage channel body with Ø 110 mm outlet ⁸⁾ **)	1000	100	010140765	3,38
MEARIN PLUS F BLACK 2000.1/100 shallow drainage channel body ^{**)}	500	100	010140767	1,69
MEARIN PLUS F BLACK 2000.1 RW/100 shallow drainage channel body for change of drain direction ¹⁵⁾ **)	500	100	010140769	1,69

**) Not suitable for the diagonal or transverse travel of motorways and highways.

8) With tight formed-in drain outlet Ø 110 mm

15) Utilization option as a flow direction change

MEARIN PLUS / F / BLACK 2000

A 15, B 125, C 250, D 400** Nominal width 200



BUILDING SUCCESS

MEARIN PLUS 2000 DRAINAGE CHANNEL WITHOUT FALL WITH GRP EDGE AND SEALING JOINT ACCORDING TO EN 1433

Channel made of glass-fibre-reinforced composite material. Clear width 200 mm, total width 236 mm. Suitable for all channel covers **MEA 200 CLIPFIX** and **MEA TS-P 200 TOPSLOT**. For the realisation of water level slopes. Loading classes A 15 to D 400** according to EN 1433. Load capacity according to specification when installed according to the MEA installation instructions.

MEARIN PLUS 2000 complete drainage channels incl. cover **)

Description	Length (mm)	Height (mm)	EAN-Code	kg/unit
MEARIN PLUS 2000.0 complete channel with galv. mesh grating-B 125-1 m CXL ^{5) 14) *) **)}	1000	242	012140790	12,67
MEARIN PLUS 2000.0 complete channel with ductile iron slotted grating-C 250-1 m CXL ^{5) 14) *) **)}	1000	242	012140792	20,70
MEARIN PLUS 2000.0 complete channel incl. HONEYCOMB grating-C 250-1 m CXL ^{5) 14) *) **)}	1000	242	012140846	19,22
MEARIN PLUS 2000.0 complete channel with ductile iron slotted grating-D 400-1 m CXL ^{5) 14) *) **)}	1000	242	012140808	23,60

*) Delivery time upon request

***) Not suitable for the diagonal or transverse travel of motorways and highways.

5) Connection option for vertical drain Ø 160 mm (drainage preformation), end caps with connector or to gullies / silt boxes.

14) Connection option for corner-, T- and cross- connections.

MEARIN PLUS / F / BLACK 2000

A 15, B 125, C 250, D 400** Nominal width 200



BUILDING SUCCESS

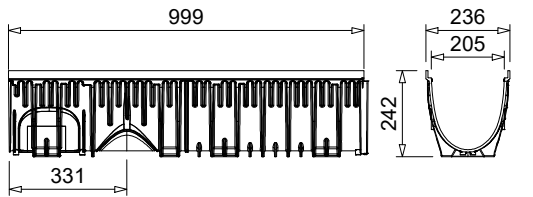

012140034

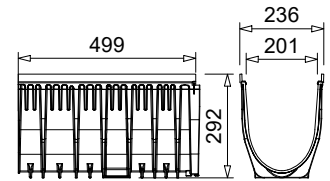

012140242

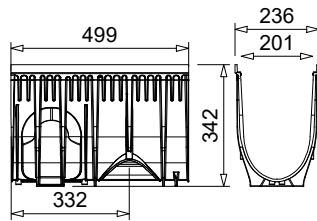

012140270

MEARIN PLUS 2000 Drainage channel body without fall, loading classes up to D 400 **)

Description	Length (mm)	Height (mm)	EAN-Code	kg/unit
MEARIN PLUS 2000.0 Drainage channel body ^{5) 14) **)}	1000	242	012140034	6,00
MEARIN PLUS 2000.1 Drainage channel body ^{3) **)}	500	242	012140036	3,35
MEARIN PLUS 2000.1 RW Drainage channel body for change of drain direction ^{5) 14) 15) **)}	500	242	012140038	3,35
MEARIN PLUS 2010.0 Drainage channel body ^{5) **)}	1000	292	012140240	7,10
MEARIN PLUS 2010.1 Drainage channel body ^{3) **)}	500	292	012140242	3,55
MEARIN PLUS 2010.1 Drainage channel body for change of drain direction ^{5) 15) **)}	500	292	012140244	3,55
MEARIN PLUS 2020.0 Drainage channel body ^{5) **)}	1000	342	012140266	7,94
MEARIN PLUS 2020.1 Drainage channel body ^{3) **)}	500	342	012140268	3,97
MEARIN PLUS 2020.1 RW Drainage channel body for change of drain direction ^{5) 15) **)}	500	342	012140270	3,97

***) Not suitable for the diagonal or transverse travel of motorways and highways.

3) Connection option for end caps with connector or for gullies / silt boxes.

5) Connection option for vertical drain Ø 160 mm (drainage preformation), end caps with connector or to gullies / silt boxes.

14) Connection option for corner-, T- and cross- connections.

15) Utilization option as a flow direction change

MEARIN PLUS / F / BLACK 2000

A 15, B 125, C 250, D 400** Nominal width 200



BUILDING SUCCESS

MEARIN PLUS 2000 CHANNEL BODY WITH FALL (0.5 %)

WITH GLASS-FIBRE-REINFORCED COMPOSITE EDGE AND SEALING JOINT ACCORDING TO EN 1433

Channels made of glass-fibre-reinforced composite. Clear width 200 mm, total width 236 mm. Suitable for all drainage channel covers **MEA 200 CLIPFIX** and **TOPSLOTS MEA TS-P 200**. For the realisation of linear slopes (with slope 0.5 %). Loading classes A 15 to D 400** according to EN 1433. Load capacity according to specification, when installed according to the MEA installation instructions.

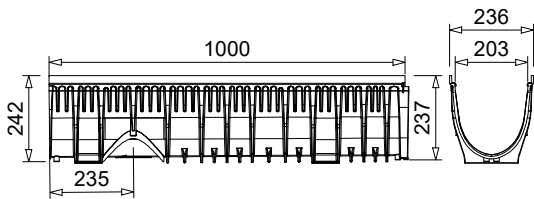

012140220

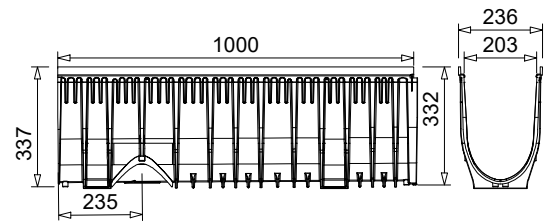

012140264

MEARIN PLUS 2000 drainage channel body with fall 0.5 %, Loading classes up to D 400 **)

Description	Length (mm)	Height (mm)	Height 2 (mm)	EAN-Code	kg/unit
MEARIN PLUS 2001 Drainage channel body ²⁾ **)	1000	242	247	012140220	6,06
MEARIN PLUS 2002 Drainage channel body ²⁾ **)	1000	247	252	012140222	6,13
MEARIN PLUS 2003 Drainage channel body ²⁾ **)	1000	252	257	012140224	6,21
MEARIN PLUS 2004 Drainage channel body ²⁾ **)	1000	257	262	012140226	6,29
MEARIN PLUS 2005 Drainage channel body ²⁾ **)	1000	262	267	012140228	6,36
MEARIN PLUS 2006 Drainage channel body ²⁾ **)	1000	267	272	012140230	6,44
MEARIN PLUS 2007 Drainage channel body ²⁾ **)	1000	272	277	012140232	6,51
MEARIN PLUS 2008 Drainage channel body ²⁾ **)	1000	277	282	012140234	6,59
MEARIN PLUS 2009 Drainage channel body ²⁾ **)	1000	282	287	012140236	6,67
MEARIN PLUS 2010 Drainage channel body ⁵⁾ **)	1000	287	292	012140238	6,74
MEARIN PLUS 2011 Drainage channel body ²⁾ **)	1000	292	297	012140246	6,82
MEARIN PLUS 2012 Drainage channel body ²⁾ **)	1000	297	302	012140248	6,89
MEARIN PLUS 2013 Drainage channel body ²⁾ **)	1000	302	307	012140250	6,97
MEARIN PLUS 2014 Drainage channel body ²⁾ **)	1000	307	312	012140252	7,05
MEARIN PLUS 2015 Drainage channel body ²⁾ **)	1000	312	317	012140254	7,12
MEARIN PLUS 2016 Drainage channel body ²⁾ **)	1000	317	322	012140256	7,20
MEARIN PLUS 2017 Drainage channel body ²⁾ **)	1000	322	327	012140258	7,27

**) Not suitable for the diagonal or transverse travel of motorways and highways.

2) Connection option for vertical drain Ø 160 mm

5) Connection option for vertical drain Ø 160 mm (drainage preformation), end caps with connector or to gullies / silt boxes.

MEARIN PLUS / F / BLACK 2000

A 15, B 125, C 250, D 400** Nominal width 200



BUILDING SUCCESS

MEARIN PLUS 2000 drainage channel body with fall 0.5 %, Loading classes up to D 400 **)

Description	Length (mm)	Height (mm)	Height 2 (mm)	EAN-Code	kg/unit
MEARIN PLUS 2018 Drainage channel body ²⁾ **)	1000	327	332	012140260	7,35
MEARIN PLUS 2019 Drainage channel body ²⁾ **)	1000	332	337	012140262	7,43
MEARIN PLUS 2020 Drainage channel body ⁵⁾ **)	1000	337	342	012140264	7,50

**) Not suitable for the diagonal or transverse travel of motorways and highways.

2) Connection option for vertical drain \varnothing 160 mm

5) Connection option for vertical drain \varnothing 160 mm (drainage preformation), end caps with connector or to gullies / silt boxes.

MEARIN PLUS 2000 ACCESSORIES

MEARIN PLUS 2000 Silt box with cover, with sediment bucket **)

Description	Length (mm)	Width (mm)	Height (mm)	EAN-Code	kg/unit
MEARIN PLUS 2000.0.EK silt box incl. ductile iron slotted grating-C 250-0.5 m CXL + sediment bucket ⁵⁾¹⁴⁾ *)**)	500	236	630	012140794	11,65

*) Delivery time upon request

***) Not suitable for the diagonal or transverse travel of motorways and highways.

5) Connection option for vertical drain Ø 160 mm (drainage preformation), end caps with connector or to gullies / silt boxes.

14) Connection option for corner-, T- and cross- connections.

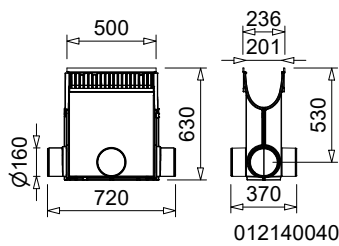

012140040

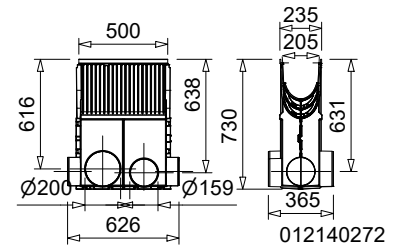

012140272

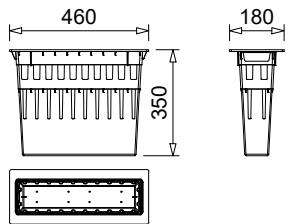

010710067

MEARIN PLUS 2000 Silt box without cover, with sediment bucket **)

Description	Length (mm)	Width (mm)	Height (mm)	EAN-Code	kg/unit
MEARIN PLUS 2000.EK silt box with outlet Ø 160 mm, incl. sediment bucket **)	500	236	630	012140040	7,60
MEARIN PLUS 2000-2020.EK Gully with pipe connector Ø 160 mm / Ø 200 mm, incl. sediment bucket **)	500	236	730	012140272	11,50
MEARIN PLUS / EXPERT 2000 sediment bucket	460	180	350	010710067	0,70

***) Not suitable for the diagonal or transverse travel of motorways and highways.

MEARIN PLUS / F / BLACK 2000

A 15, B 125, C 250, D 400** Nominal width 200



BUILDING SUCCESS

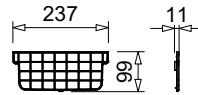

010140768

MEARIN PLUS F (BLACK) 2000 End caps for shallow channel

Description	Material	Height (mm)	EAN-Code	kg/unit
MEARIN PLUS F 2000.SE End cap closed for shallow channel start/end	PC	100	010140768	0,04
MEARIN PLUS F BLACK 2000.SE End cap closed for shallow channel start/end	PC	100	010140771	0,04

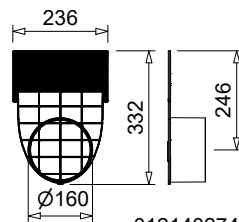

012140274

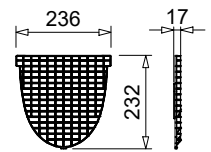

010140108

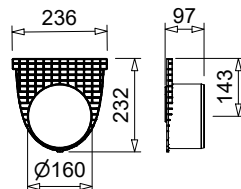

010140110

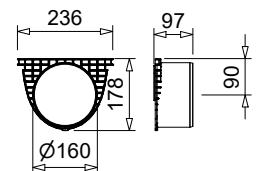

010140112

MEARIN PLUS/EXPERT 2000 End caps

Description	Material	Height (mm)	EAN-Code	kg/unit
MEARIN PLUS/EXPERT 2000-2020.SE/Ø160 End cap closed, for channel start/end with preforming for Ø 160 mm pipe connection	PC	332	012140274	0,30
MEARIN PLUS/EXPERT 2000.SE End cap closed for channel start/end	PP	232	010140108	0,18
MEARIN PLUS/EXPERT 2000.E End cap with outlet Ø 160 mm for channel end	PP	232	010140110	0,19
MEARIN PLUS/EXPERT 2000.ES End cap with outlet Ø 160 mm for lateral channel connector *)	PP	178	010140112	0,24

*) Delivery time upon request

MEARIN PLUS / F / BLACK 2000

A 15, B 125, C 250, D 400** Nominal width 200



BUILDING SUCCESS

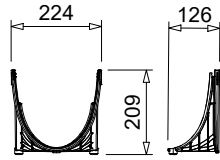

010140114

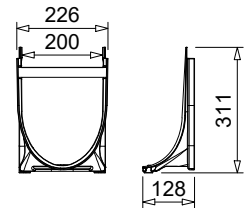

010140890

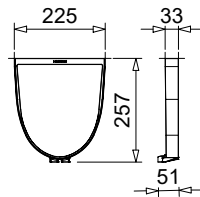

010140892

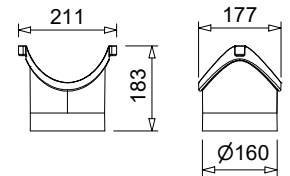

010140117

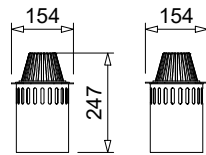

010140546

MEARIN PLUS/EXPERT 2000 Connection accessories

Description	Material	Length (mm)	Width (mm)	Height (mm)	EAN-Code	kg/unit
MEARIN PLUS/EXPERT 2000.0 adapter for lateral channel connection, to corner, T and cross connections	PP	126	224	209	010140114	0,09
MEARIN PLUS/EXPERT 2010.0 adapter for lateral channel connection, for corner, T and cross connections	PC	128	226	261	010140628	0,15
MEARIN PLUS/EXPERT 2020.0 adapter for lateral channel connection, for corner, T and cross connections	PC	128	226	311	010140890	0,16
MEARIN PLUS/EXPERT 2010.T channel connector for low point channels no. 10	PC	51	225	257	010140892	0,09
MEARIN PLUS/EXPERT 2020.T channel connector for low point channels no. 20	PC	51	220	307	010140894	0,10
MEARIN PLUS/EXPERT 2000 Vertical outlet connection Ø 160 mm	PP	-	-	182	010140117	0,14
MEARIN PLUS/EXPERT 2000 Odour trap with dirt filter and dirt trap	PP, Galv. steel	-	-	-	010140546	2,00

MEARIN PLUS / F / BLACK 2000

A 15, B 125, C 250, D 400** Nominal width 200

**BUILDING SUCCESS****Jointing compounds for STANDARD applications ***)**

Description	Material	EAN-Code	kg/unit
SABA MS Floor GREY sealant 600 ml in a bag, stable ***)	MS-polymer-basis	010152708	0,88
SABA MS Floor BLACK sealant 600 ml in a bag, stable ***)	MS-polymer-basis	010152700	0,84
SABA Primer 9102 for undercoat, 1 liter	Silane-basis	010155803	0,92
Joint Cleaner solvent 48, 1 liter, Cleaner for adhesive flanks	-	010155807	0,84
Dispensing gun for 600 ml bags	-	010152707	0,63

***) For watertight mounting of drainage channels (only for channels transporting rain water). Not suitable for installation in LAU facilities, gaz stations or similar constructions