

MEAKERB BRIDGE KERB CHANNEL**MATERIAL CHARACTERISTICS**

DRAINAGE CHANNEL AND COMPONENTS	
POLYMER CONCRETE	on a Polyester resin basis, with mineral fillers, additives
COMPRESSION RESISTANCE	≥ 90 N/mm ²
FLEXURAL TENSILE STRENGTH	≥ 22 N/mm ²
MODULES OF ELASTICITY	25.000 – 35.000 N/mm ²
DENSITY	2,1 – 2,3 kg/dm ³
LINEAR EXPANSION COEFFICIENT	approx. 1,45 x 10 ⁻⁵ 1/K
HEAT RESISTANCE	100°C permanent exposure, short-term exposure (5 min.) to 200°C
FROST RESISTANCE	- 50°C
WATER PENETRATION LEVEL	0 mm
WATER ABSORPTION	< 0,05% DIN 52 103 (A)
MATERIAL STRUCTURE	capillary free

Stainless steels form a dense chromium oxide layer (passive layer) under the influence of oxygen to protect against corrosion. Contamination by environmental influences, such as rust film, Sulphur dioxides, soot particles, road salt, table salt, chloride-containing aqueous liquids, can lead to permanent damage of the protective layer.

It is therefore imperative to clean stainless steel products regularly. Under no circumstances should normally steel wool or steel brushes be used for cleaning, as abrasion can cause extraneous rust to form.

We recommend cleaning with steam cleaners and/or steel-free brushes, using suitable (hydrochloric acid-free) stainless steel cleaners.

PURPOSE OF USE

Component for the line drainage of surfaces in order to collect, transport and discharge rainwater from adjacent fixed surfaces.

MEAKERB BRIDGE 160

A 15, B 125, C 250, D 400

CW 160

BUILDING SUCCESS

MEAKERB BRIDGE 160 BRIDGE DRAINAGE MONOLITHIC POLYMER CONCRETE CHANNELS WITH EPDM SEALINGS

Kerb channels for linear bridge drainage in accordance with BAST and ZTV-ING guidelines. For installation in the bridge deck. Clear width of the channel body 160 mm, total width 220 mm. Loading class D 400 according to EN 1433. Load capacity according to specification when installed according to the MEA installation instructions.

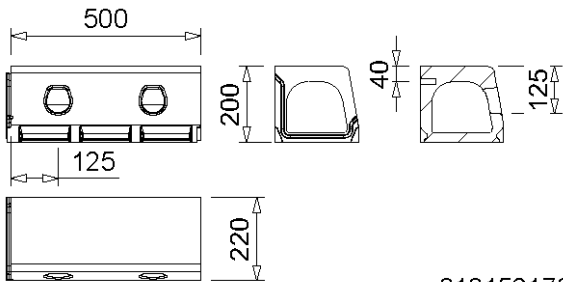

010152170

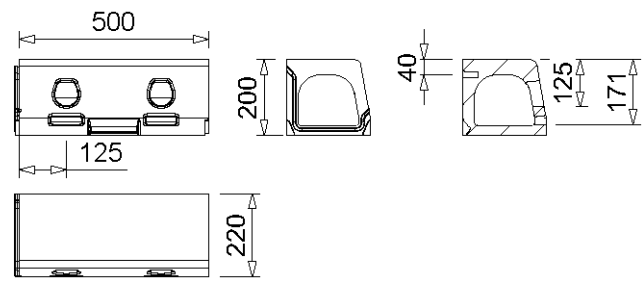

010152184

MEAKERB BRIDGE 160-125 KERB CHANNEL, HEIGHT OF CURB 125 MM, FLOW CROSS-SECTION 190 CM², WITH REINFORCEMENT PREFORMED ON THE REAR SIDE

Designation	Ord. No.	Length [mm]	Height [mm]	Inlet Ø cm ² /m lateral	kg/unit
MEAKERB BRIDGE 160-125 kerb channel incl. butt joint seal with connector for vertical outlet Ø 160 mm	010152170	500	200	125	22,58
MEAKERB BRIDGE 160-125 OPA kerb channel, for porous asphalt incl. butt joint seal with connector for vertical outlet Ø 160 mm	010152184	500	200	185	22,80

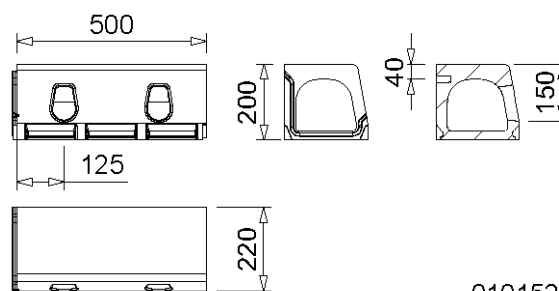

010152174

MEAKERB BRIDGE 160-150 KERB CHANNEL, KERB HEIGHT 150 MM, FLOW CROSS-SECTION 43 CM², WITH REAR REINFORCEMENT PREFORMING

Designation	Ord. No.	Length [mm]	Height [mm]	Inlet Ø cm ² /m lateral	kg/unit
MEAKERB BRIDGE 160-150 kerb channel incl. butt joint seal with connector for vertical outlet Ø 160 mm *)	010152174	500	200	175	22,48

*) Delivery time upon request.

MEAKERB BRIDGE 160

A 15, B 125, C 250, D 400

CW 160



BUILDING SUCCESS

MEAKERB BRIDGE 160 ACCESSORIES

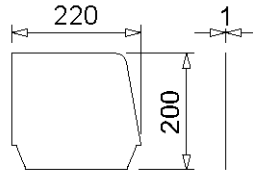

010152180

MEAKERB END CAPS

Designation	Ord. No.	Material	Height [mm]	kg/unit
MEAKERB BRIDGE 160.SE end cap made of galv. steel for channel start/end	010152180	Galv. steel	200	0,40
MEAKERB BRIDGE 160.SE end cap made of stainl. steel (AISI 316) for channel start/end	010152218	Stainl. steel (AISI 316)	200	0,30

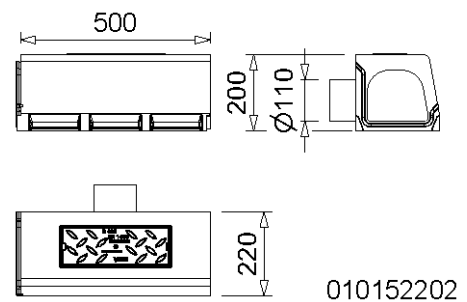
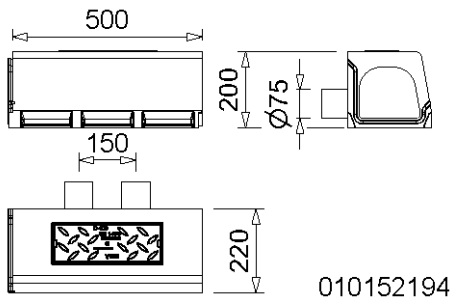
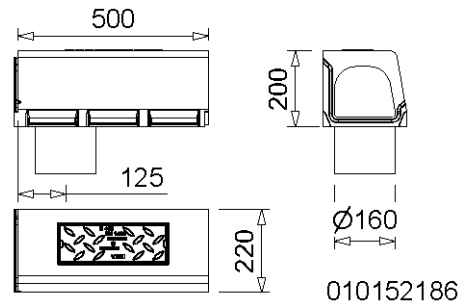
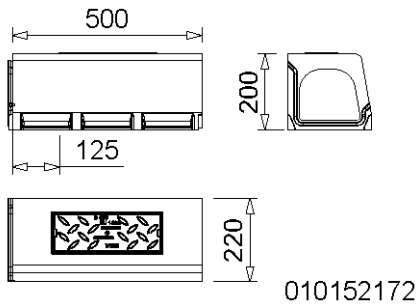

MEAKERB BRIDGE 160-125 AND 160-150 INSPECTION ELEMENTS

Designation	Ord. No.	Length [mm]	Height [mm]	kg/unit
MEAKERB BRIDGE 160 kerb channel with inspection opening, incl. closed cover, incl. butt joint seal with connector for vertical outlet Ø 160 mm	010152172	500	200	23,78
MEAKERB BRIDGE 160 kerb channel with inspection opening, incl. closed cover, incl. butt joint seal, with vertical socket Ø 160 mm stainl. steel 1.4571 (AISI 316)	010152186	500	200	23,78
MEAKERB BRIDGE 160 kerb channel with inspection opening, incl. closed cover, incl. butt joint seal with two horizontal sockets Ø 75 mm stainl. steel 1.4571 (AISI 316), rear	010152194	500	200	23,78
MEAKERB BRIDGE 160 kerb channel with inspection opening, incl. closed cover, incl. butt joint seal with horizontal socket Ø 110 mm stainl. steel 1.4571 (AISI 316), rear	010152202	500	200	23,90

MEAKERB BRIDGE 160

A 15, B 125, C 250, D 400

CW 160



BUILDING SUCCESS

MEAKERB BRIDGE 160-125 AND 160-150 EXPANSION JOINT SET

Designation	Ord. No.	Material	Length [mm]	kg/unit
MEAKERB BRIDGE 160.expansion joint set-1.3 m for unimpeded water flow over expansion joints	010152237	Polymer concrete, Stainl. Steel (AISI 316)	1300	60,50

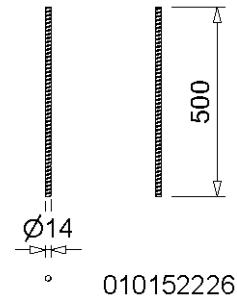
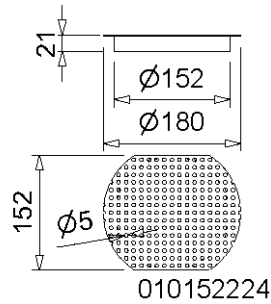

MEAKERB BRIDGE ACCESSORIES

Designation	Ord. No.	Material	kg/unit
MEAKERB BRIDGE Dirt grille in stainl. steel (AISI 316) for drain outlets Ø 160 mm	010152224	Stainl. steel (AISI 316)	0,30
MEAKERB BRIDGE reinforcement bars M12, 0.5 m long, for gluing into the back of MEAKERB BRIDGE 200 kerb channel	010152226	GRP	0,14
MEA ResiFix PY composite mortar (styrene-free) 165 ml cartridge + 2 mixing outlets *)	010504205	Polyester resin 2-component	0,35
For installation with mastic asphalt: MEA pressed gasket flange drain. Floor/ceiling drain stainless steel, outer Ø 274 mm, incl. mortar barrier. Connector for vertical outlet Ø 160 mm.	010152228	Stainl. steel (AISI 316)	7,70

*) Delivery time upon request.

This edition of the technical data sheet is valid from February 2024 until the publication of a revised version and replaces earlier publications. The current version is available for download at www.mea-group.com.

MEA Bautechnik GmbH
 Business unit Water Management
 Sudetenstraße 1
 86551 Aichach
 Tel.: +49 (0) 82 51. 91 0
 Fax: +49 (0) 82 51. 91 13 06
 E-Mail: info@mea-group.com
www.mea-group.com