

Základní typy mostních říms MEA/SYTEC

MG 01
MG 05



H-30,40,48,55,57,60,65,70,75,80 W-4 L-100
H-50,65 W-8 L-100
H-60,65,100 W-4 L-50

MG 02
MG 03
MG 04



na kotvy

MG 06



H -
L -
W - 4

MG 09

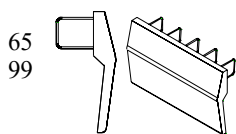

65
99

H - 52,54,60,75
L - 99
W - 11

MG 10

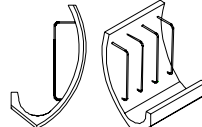

H - 65,72.5
L - 50
W - 44

a) MG 12
b) MG 13



a) H - 74,7
L - 99
W - 5/8
b) H - 60, 30
L - 100
W - 4/6

MG 14

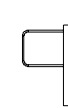

H - 40
L - 99
W - 4/8

MG 16

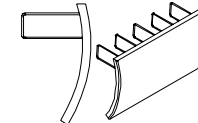

H - 40,60,65
L - 99
W - 4

MG 17



H - 75
L - 49
W - 4

MG 19

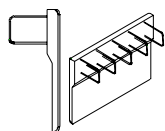

H - 50,70,100
L - 50,99
W - 4/7, 5/10

MG 20

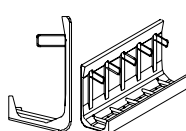

H - 60,65,70,80
L - 99
W - 25,30,35

MG 26

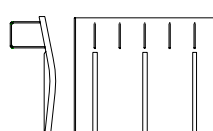

H - 85
L - 50,99
W - 11

MG 27

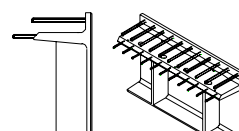

H - 120
L - 198
W - 30

MG 28

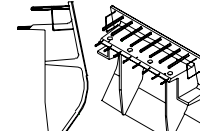

H - 170
L - 198
W - 51

MG 36

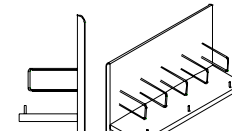

H - 65
L - 100
W - 4

MG 38

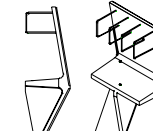

H - 130
L - 59
W - 4

MG 40

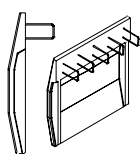

H - 100
L - 99
W - 12

MG 41

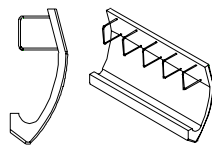

H - 69
L - 99
W - 26

MG 43

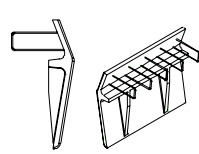

H - 80
L - 99
W - 16

MG 44

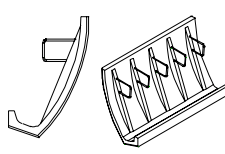

H - 60
L - 99
W - 40

MG 46

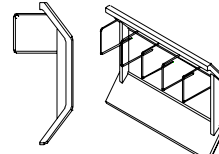

H - 80
L - 99
W - 4

MG 47

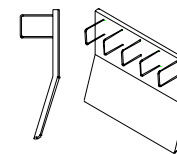

H - 80
L - 99
W - 4

MG 48

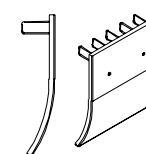

H - 125
L - 99
W - 5

MG 50

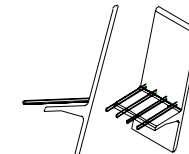

H - 135.5
L - 60
W - 4

MG 51

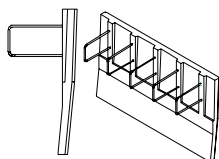

H - 60,100
L - 100
W - 4

MG 55

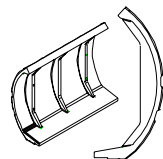

H - 118.5
L - 149
W - 6.5

MG 57

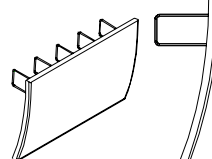

H - 70
L - 100
W - 4

Rozměry v cm

